



WARNING! The information contained herein is compiled from other documentation and may contain errors, omissions or inaccuracies. The Town of Bradford West Gwillimbury, its officers, employees and agents are not responsible for, and the users by accepting this document hereby waive as against the said Town, its officers, employees, agents, any claim for damages arising from or in any way related to any errors, omissions, misrepresentation or inaccuracies contained in this document whether due to negligence or otherwise. Any user is advised to verify all information and assume all risk in relying on the information contained herein.

Revision Date: January, 2025

1:30000



Schedule 'B' - Key Map



See
Schedule
'A'

2

LINE 9

FD

7



See
Schedule
'A'

YONGE STREET

1

3

LINE 9

FD

T8(H1)

FD

ER

GRANDVIEW CRESCENT

ER

ER

FD

GRANDVIEW CRESCENT

M1*3

8

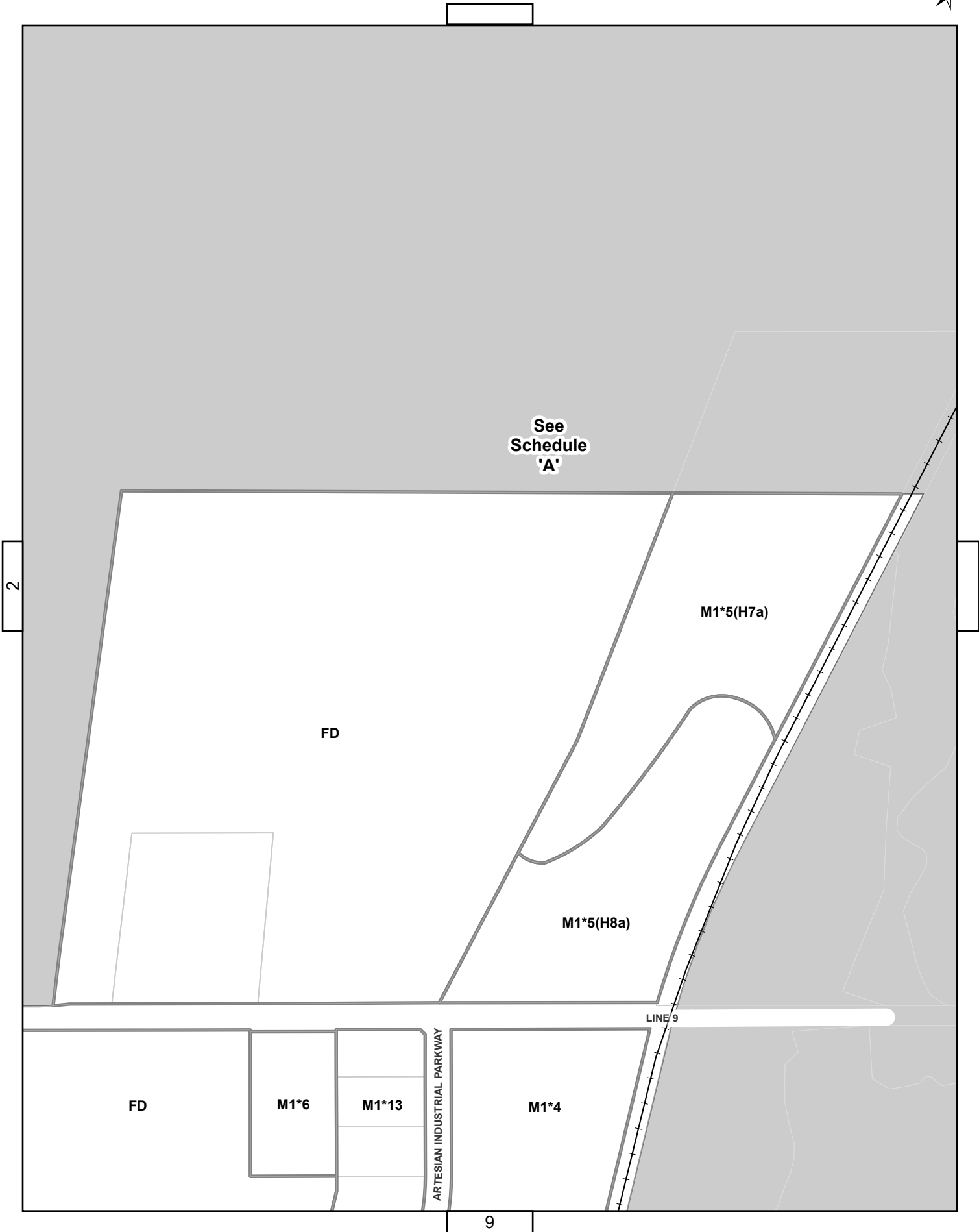

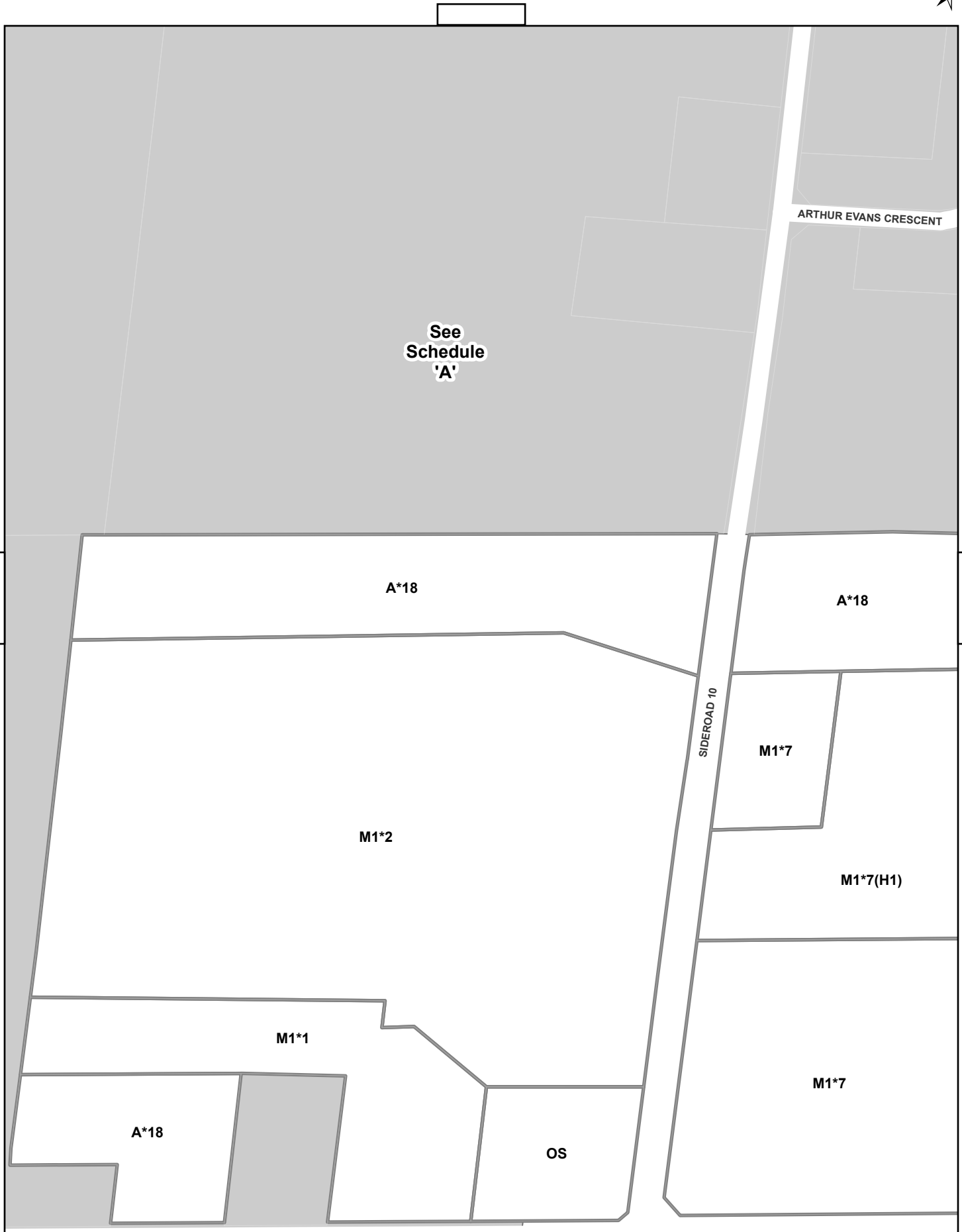

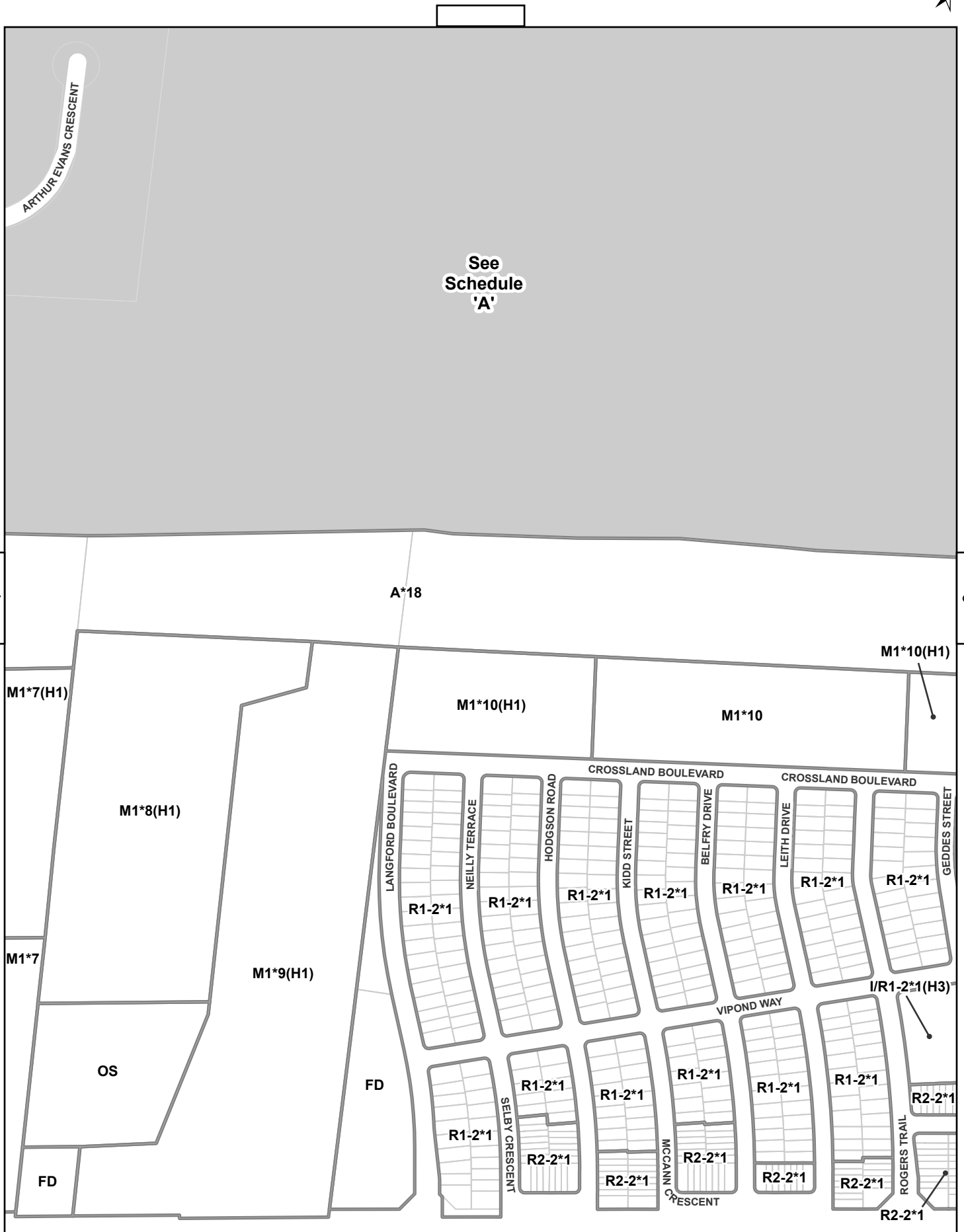

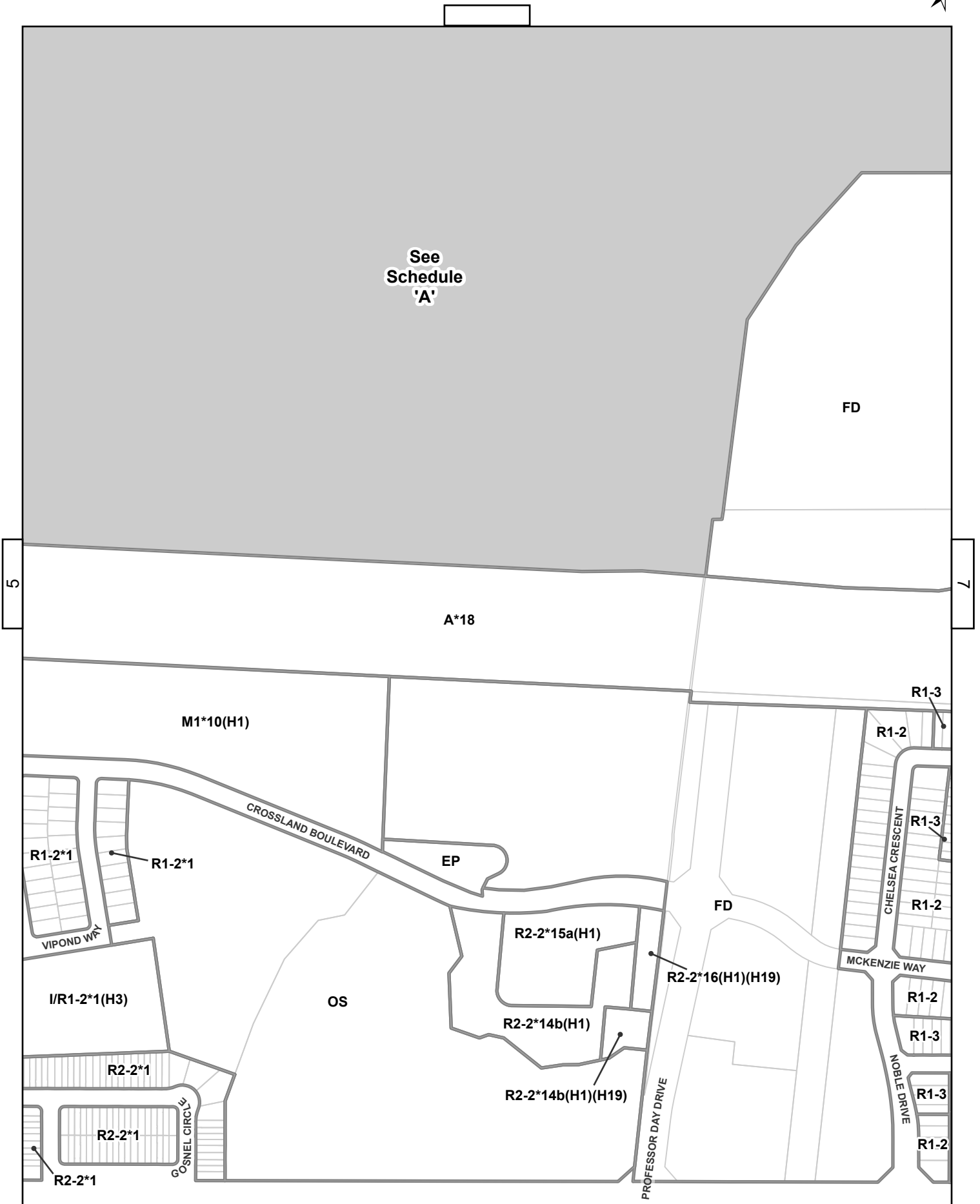

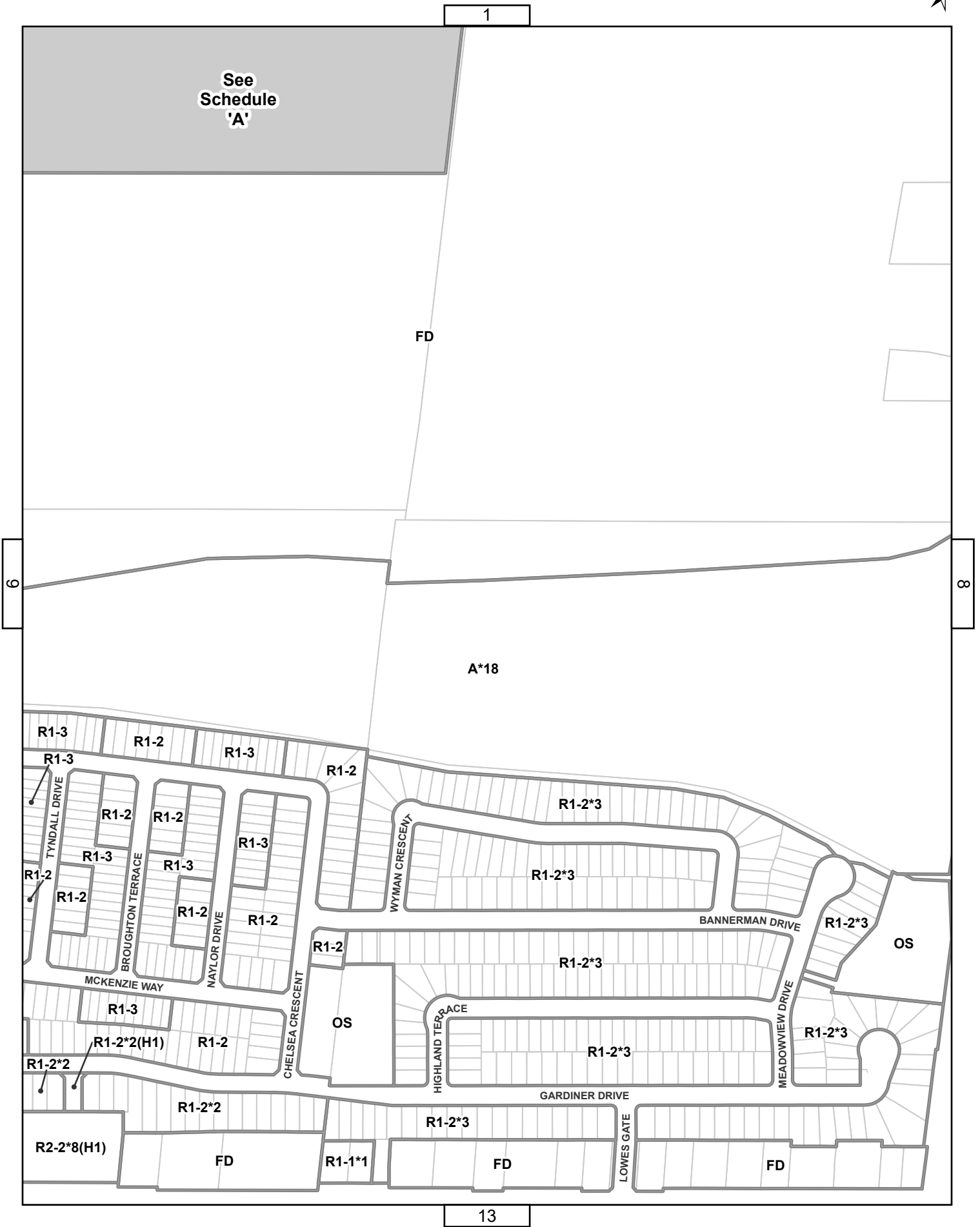



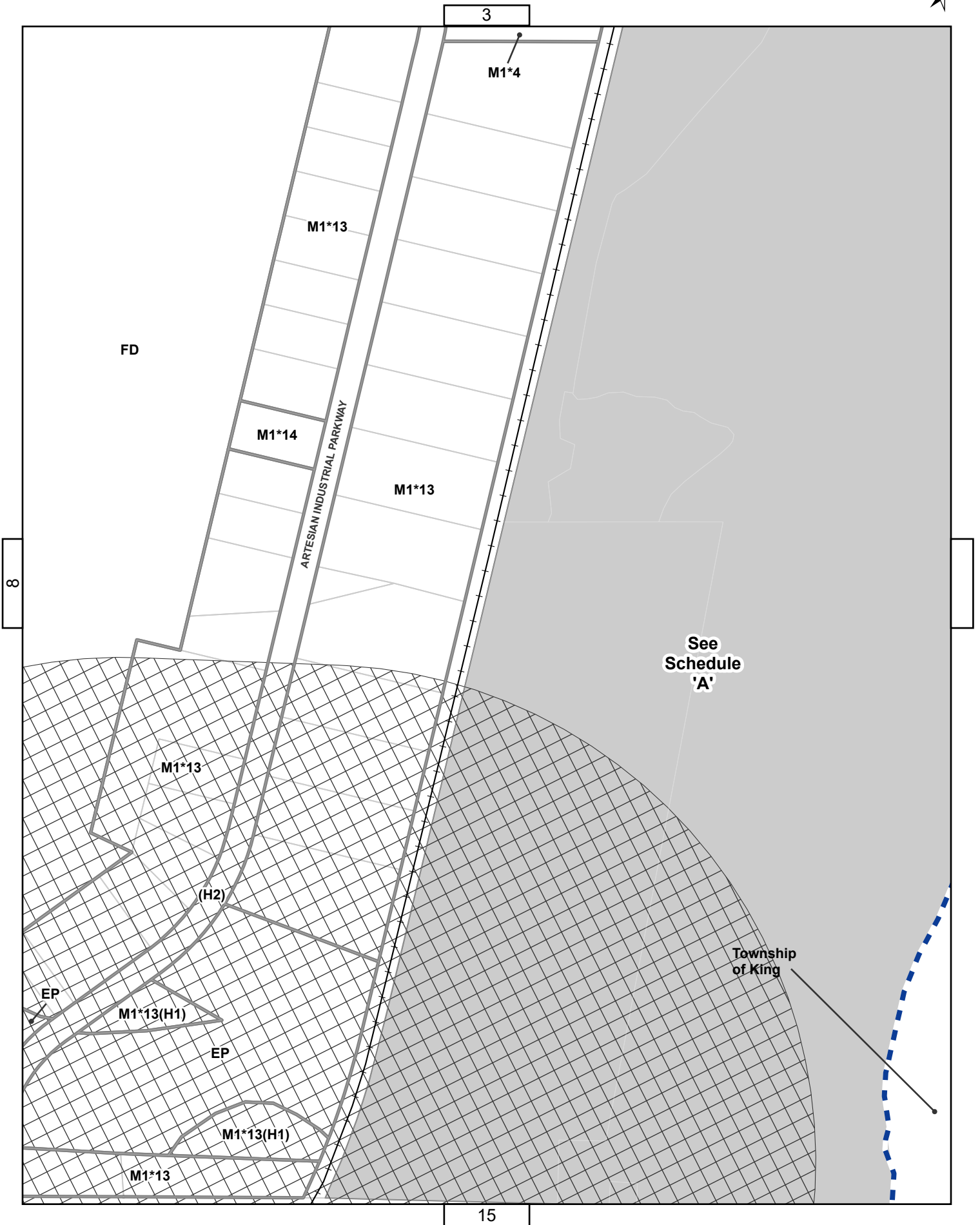



4

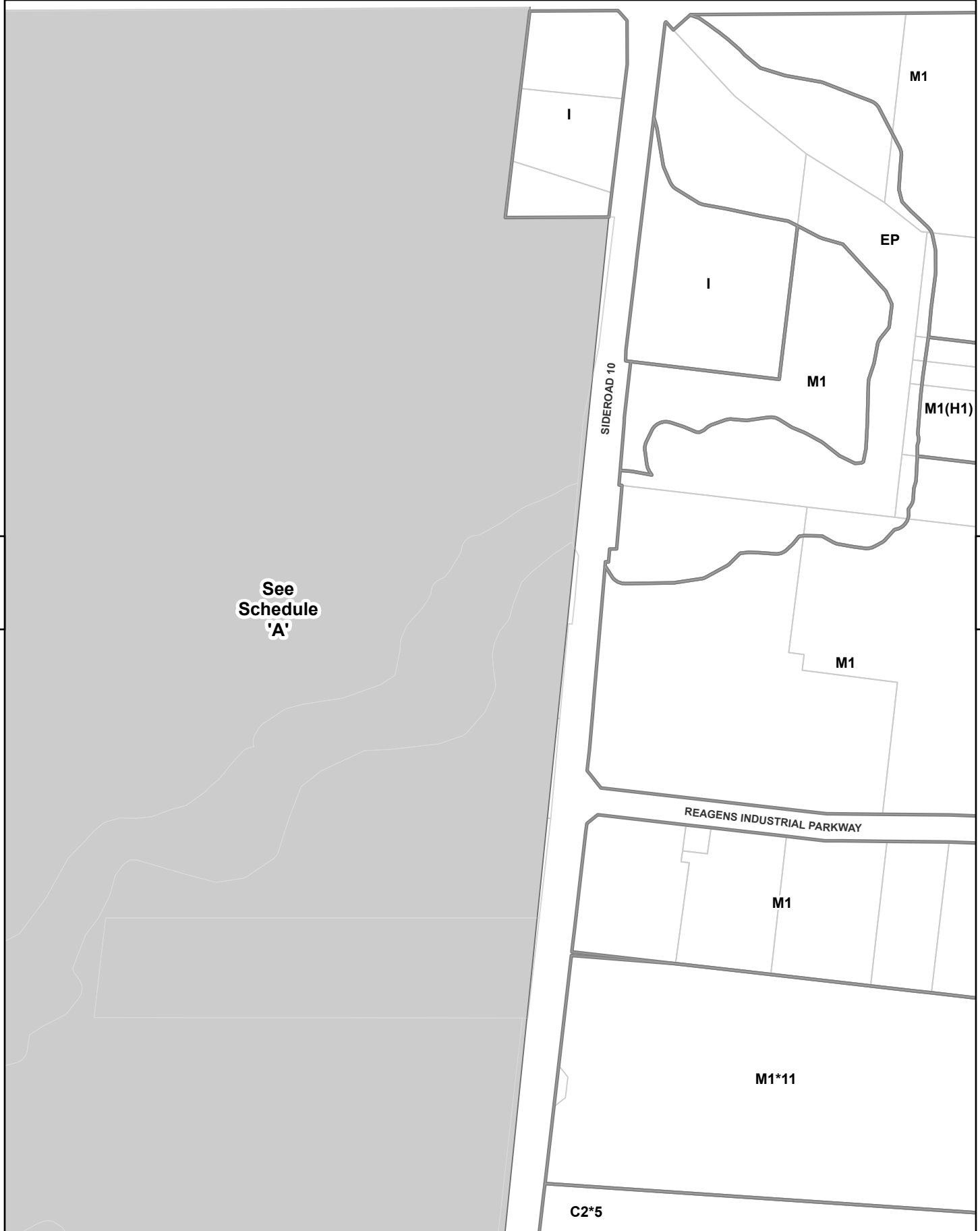

See
Schedule
'A'

SIDEROAD 10

REAGENS INDUSTRIAL PARKWAY

11

16



5



10

12

17

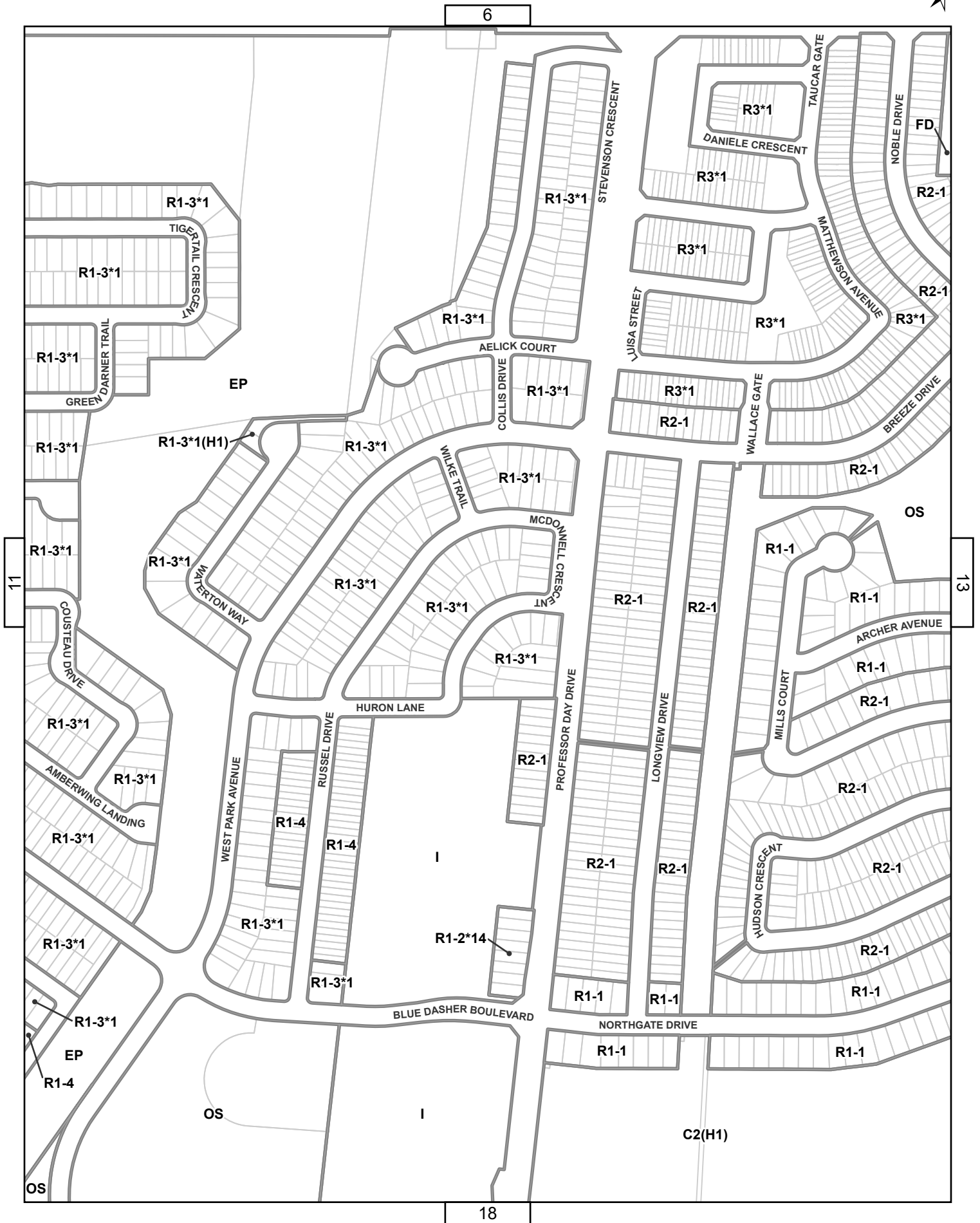



7

12

14

19

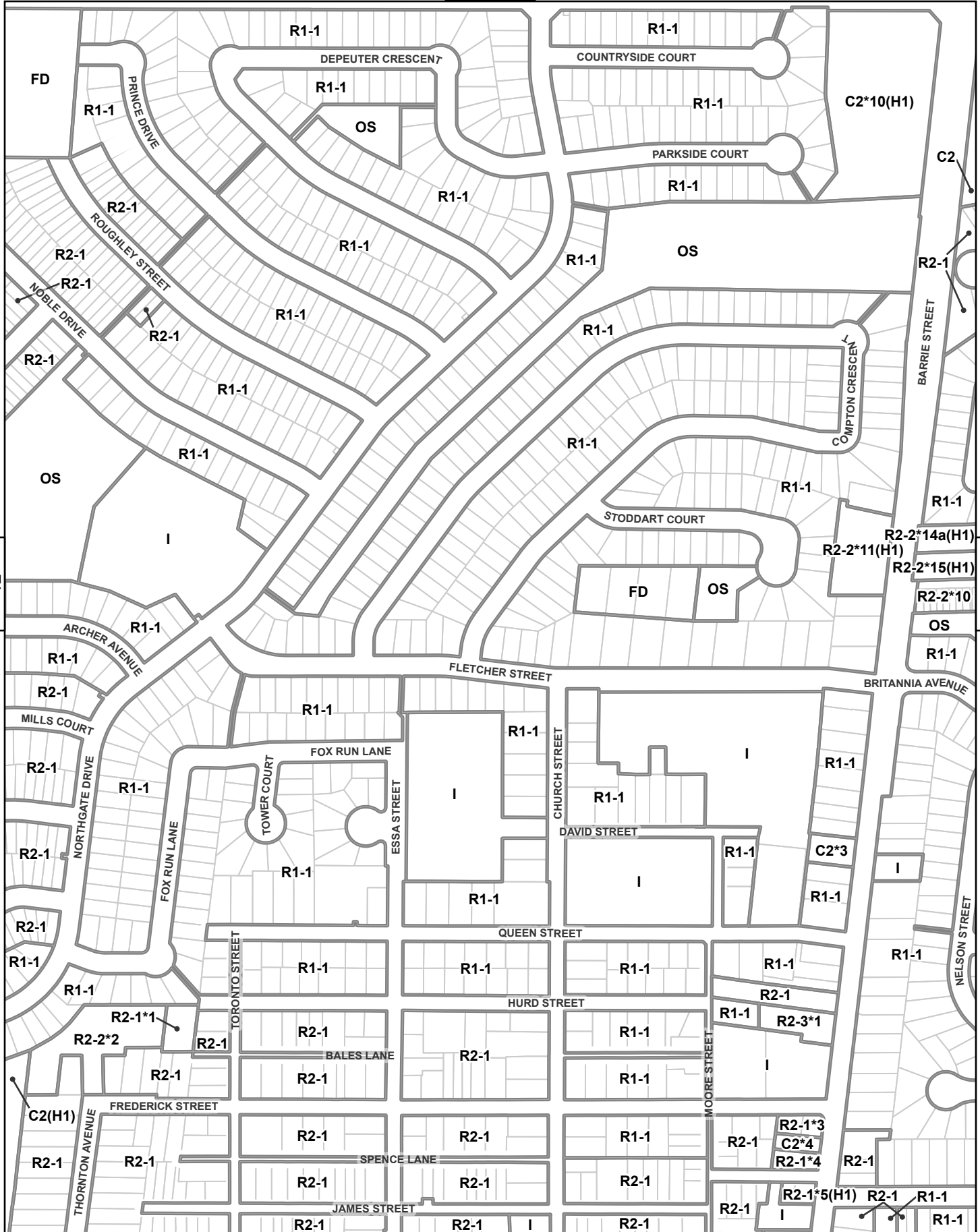

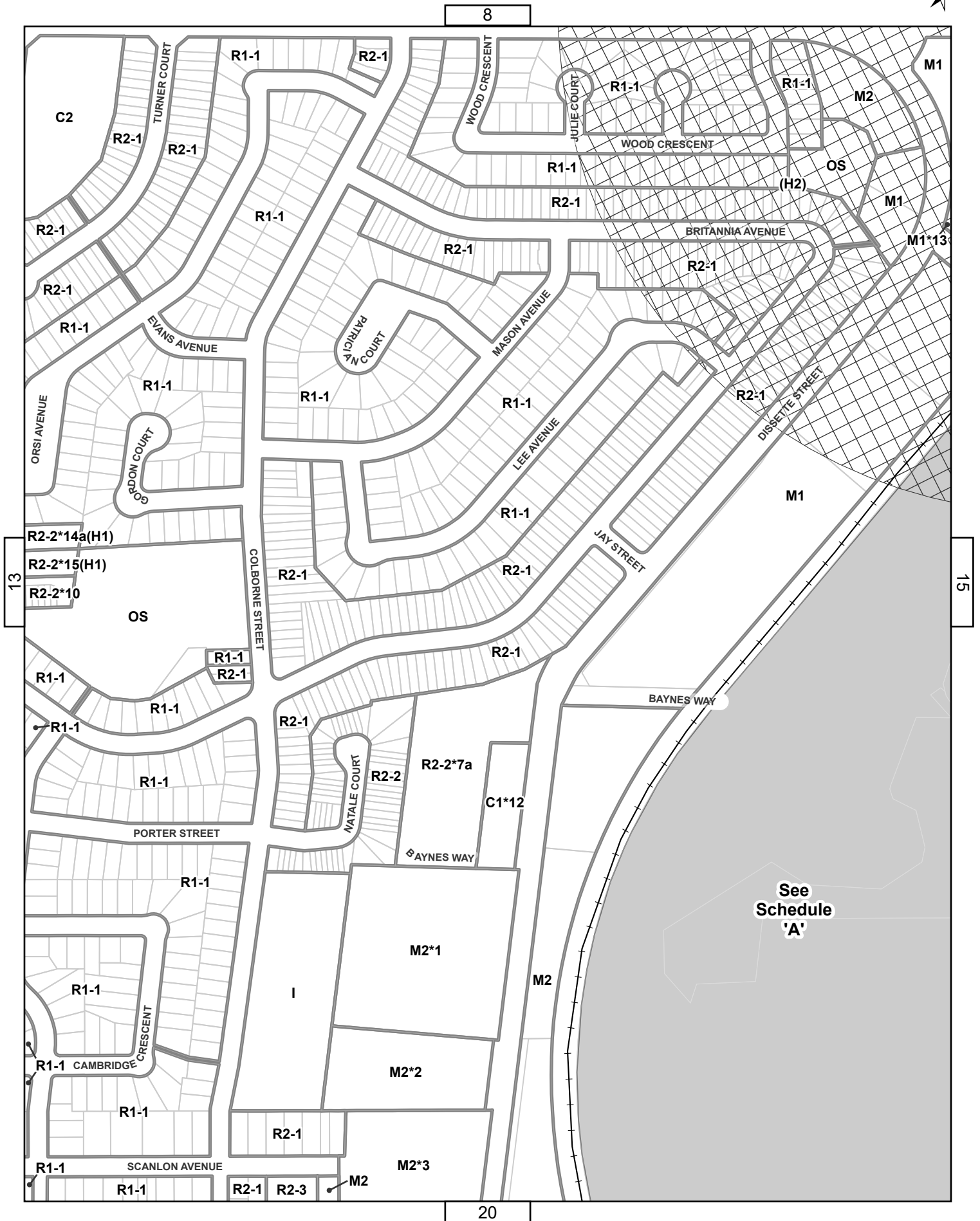

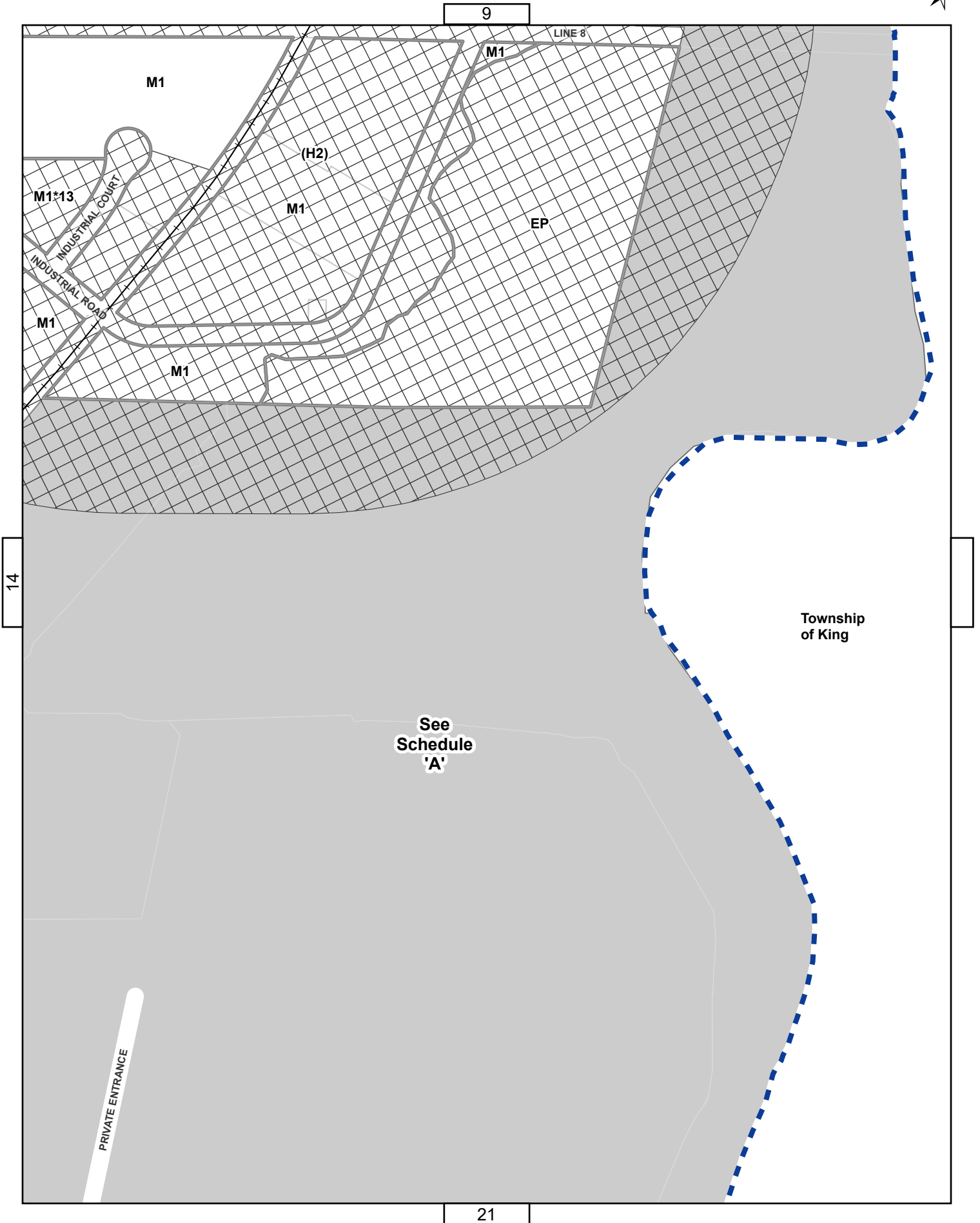

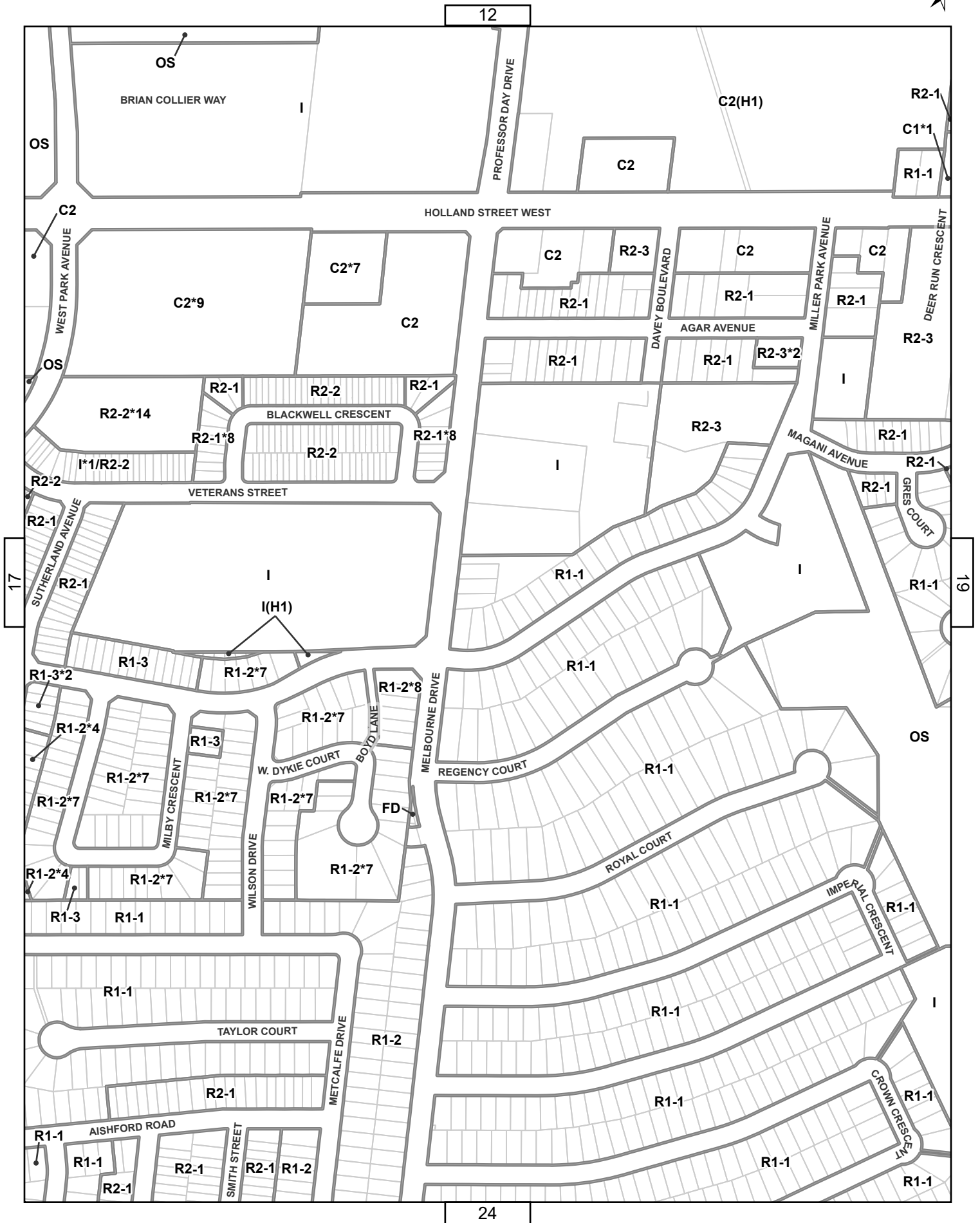

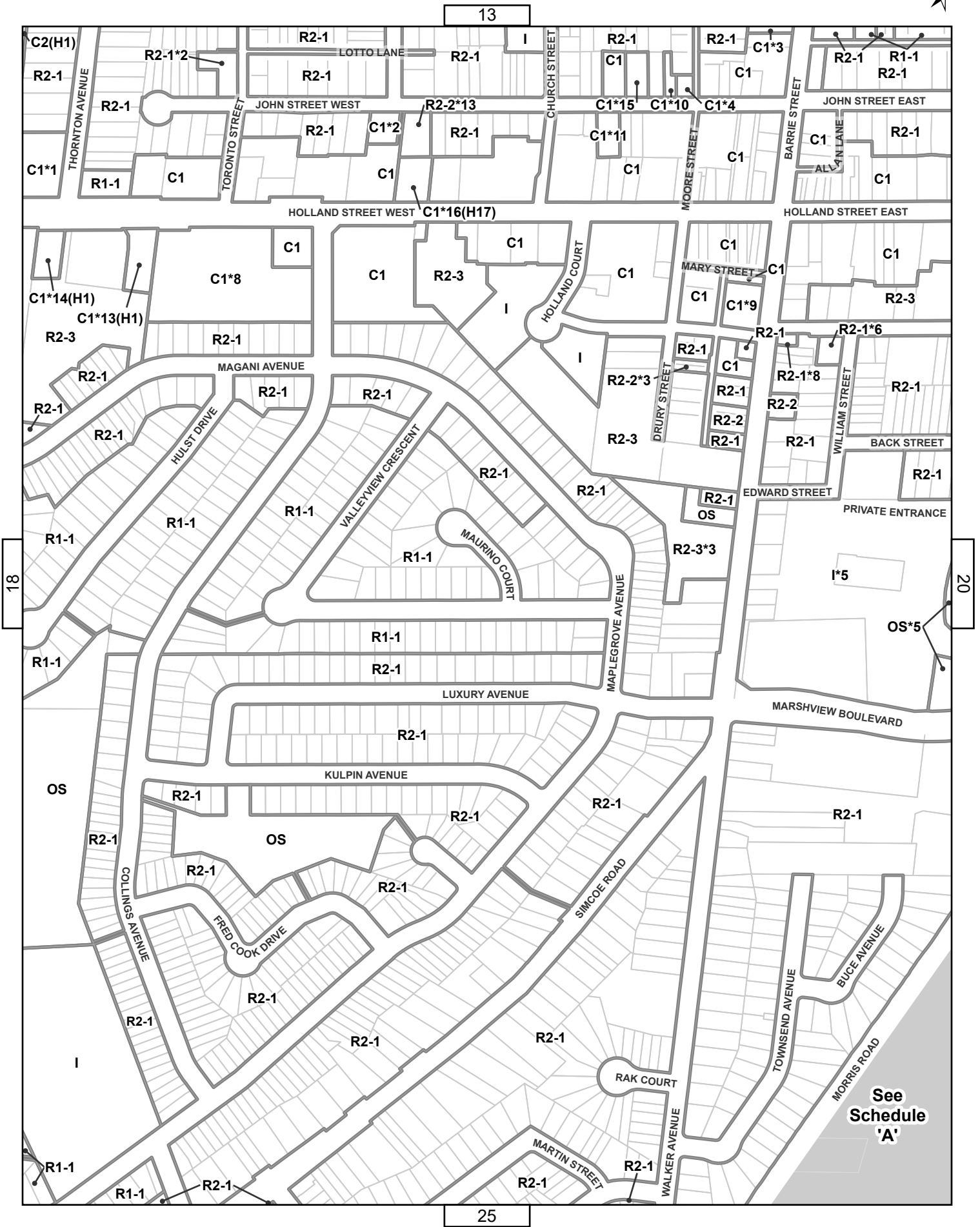

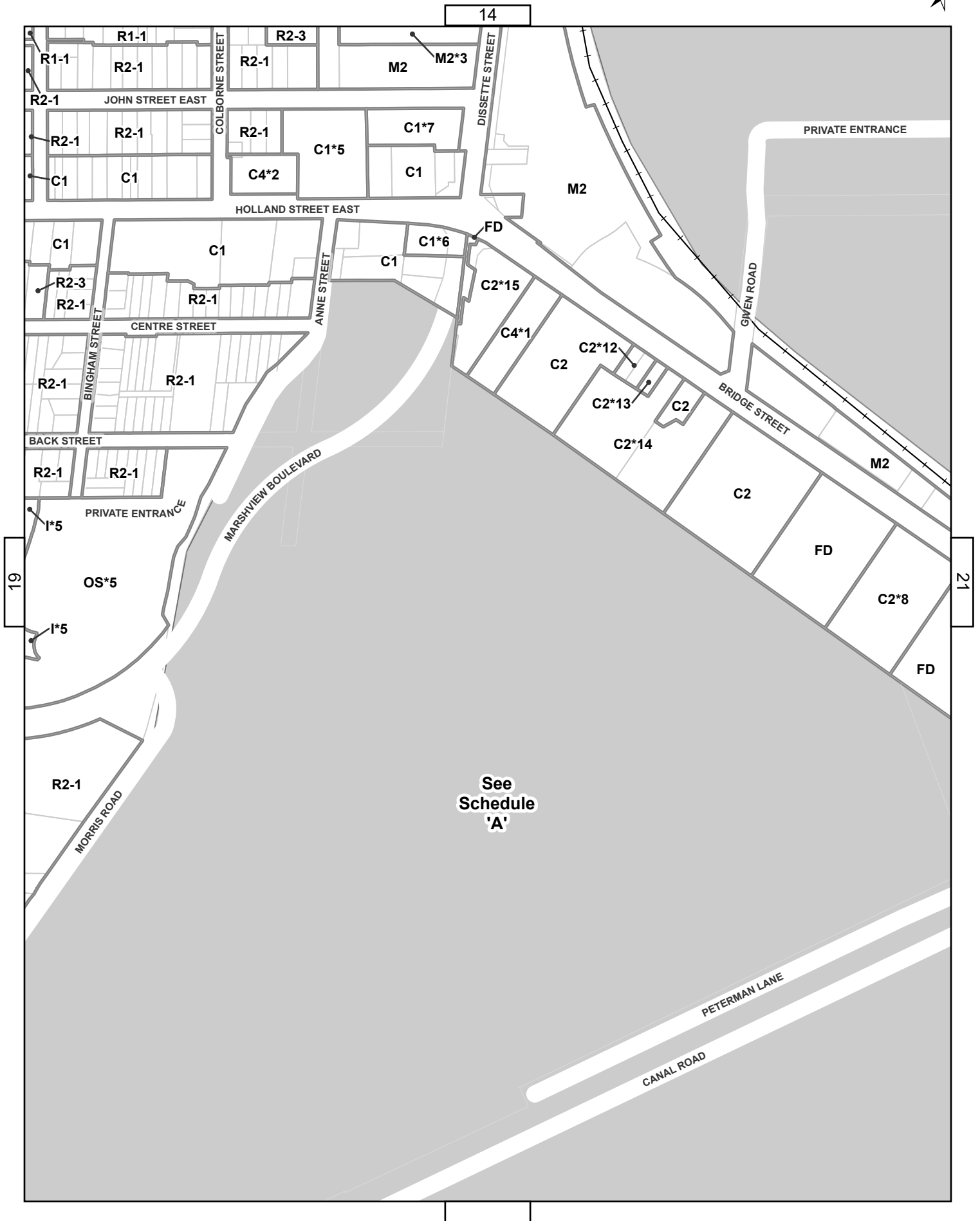



15

PRIVATE ENTRANCE

See
Schedule
'A'

PRIVATE DRIVE

M2

C2*8

BRIDGE STREET

FD

CANAL ROAD

PETERMAN LANE

PUMPHOUSE ROAD

Township
of King

20

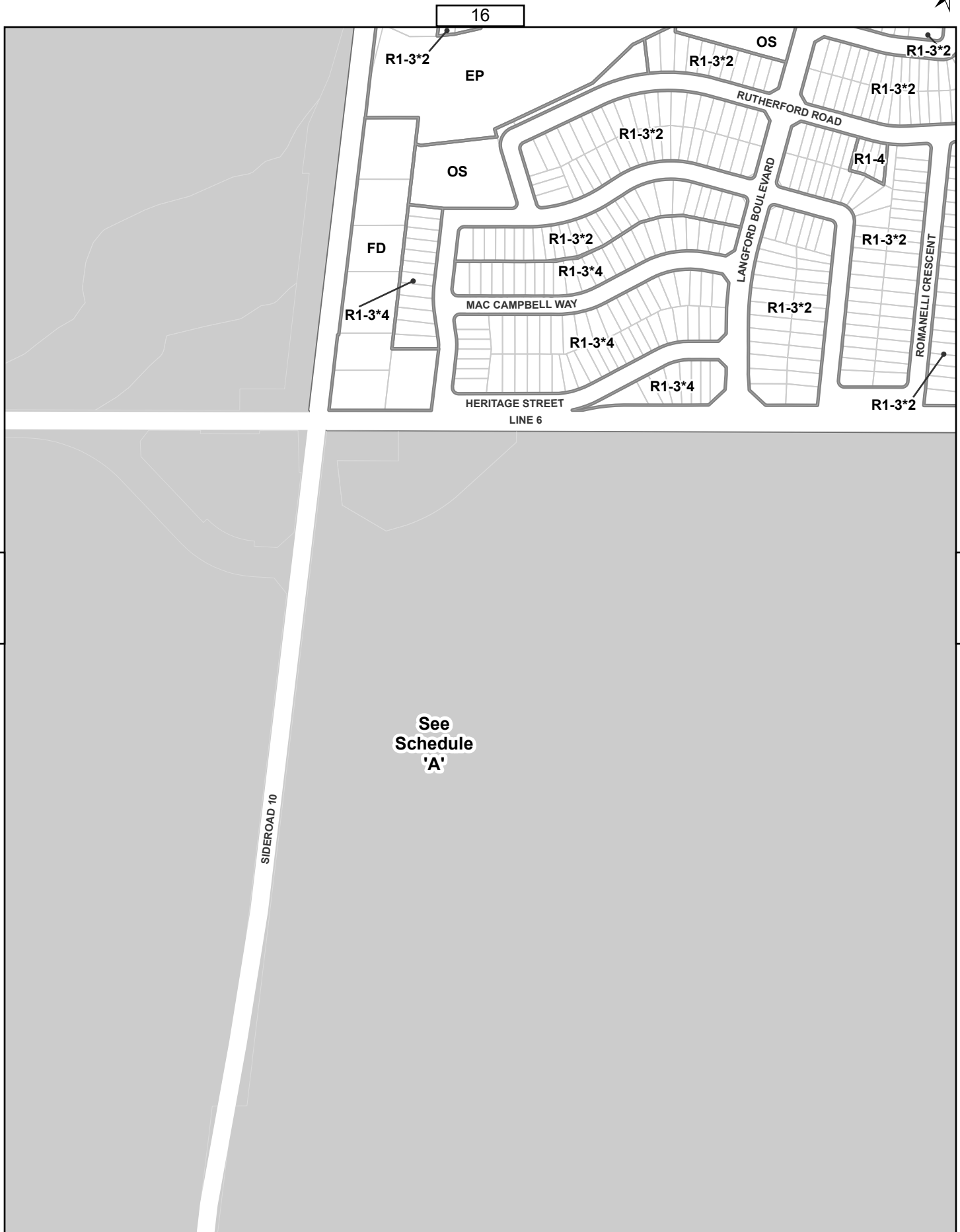

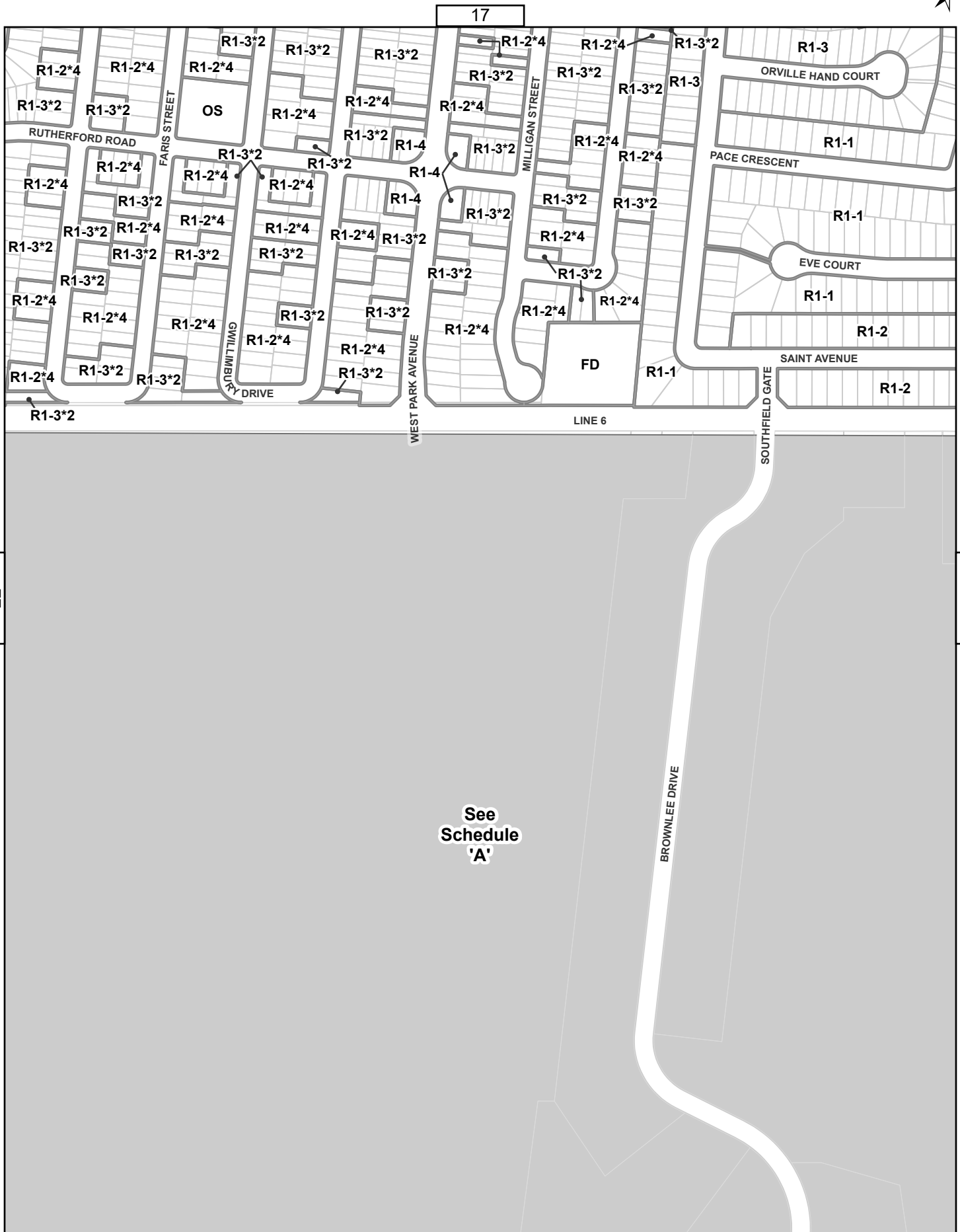

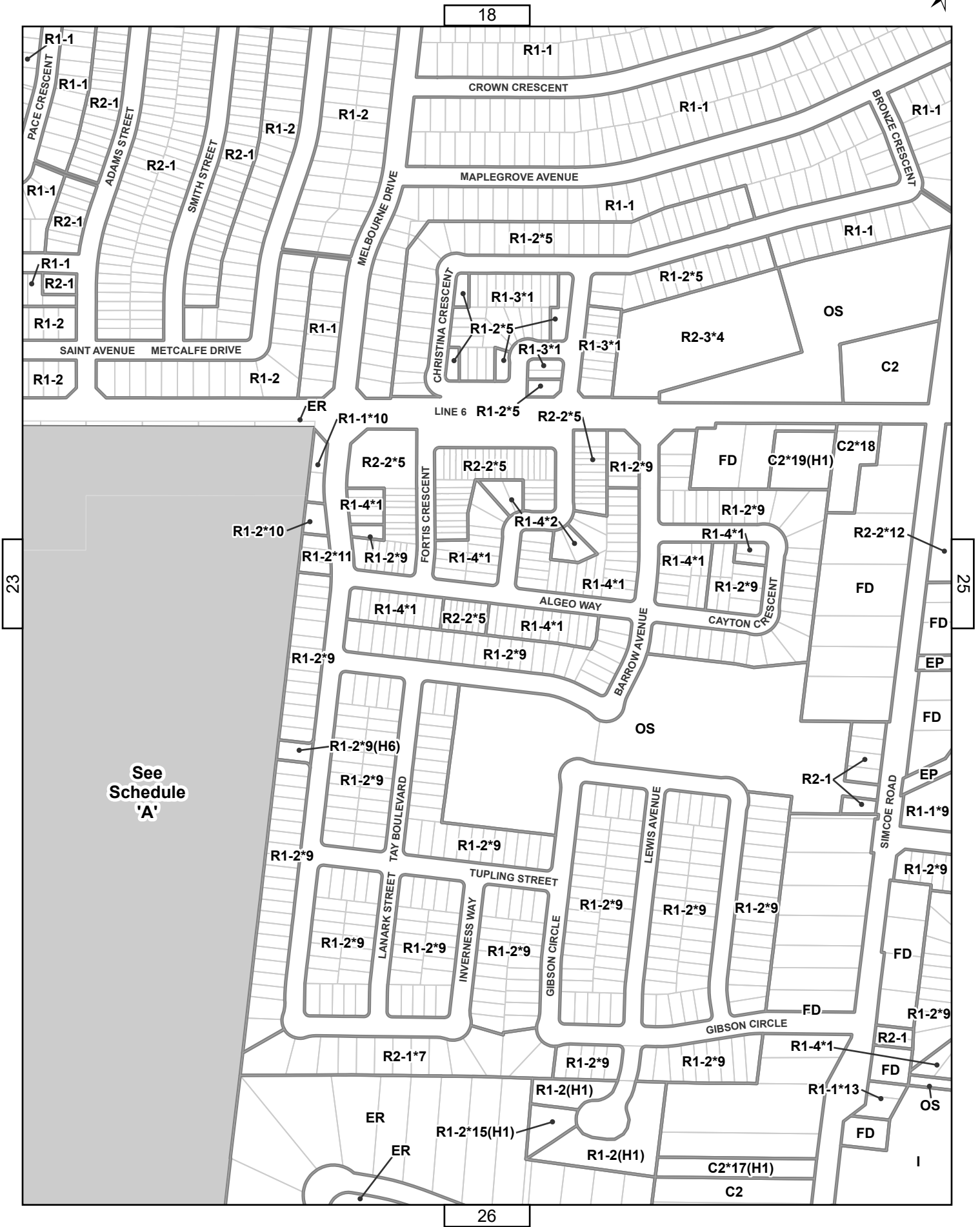

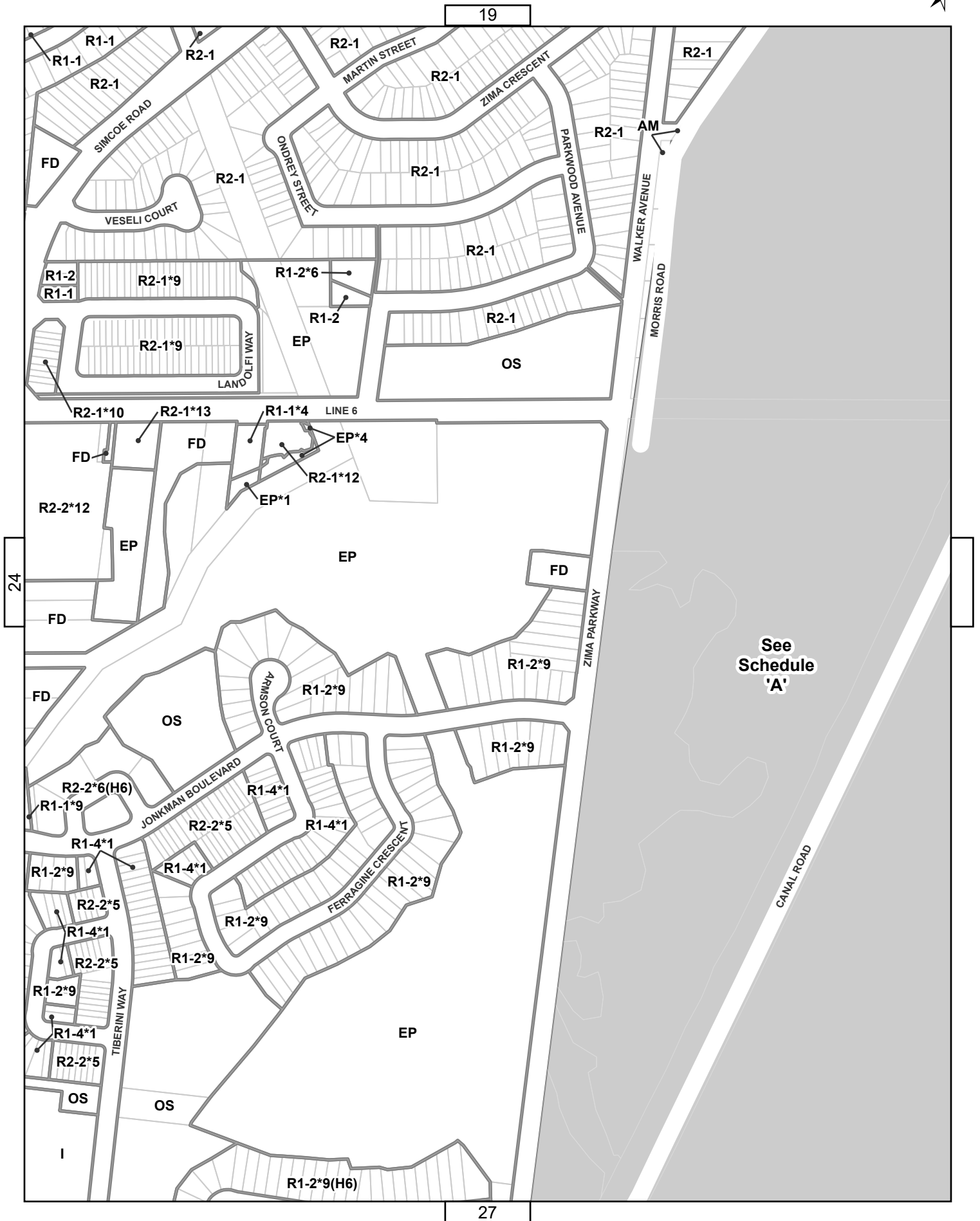

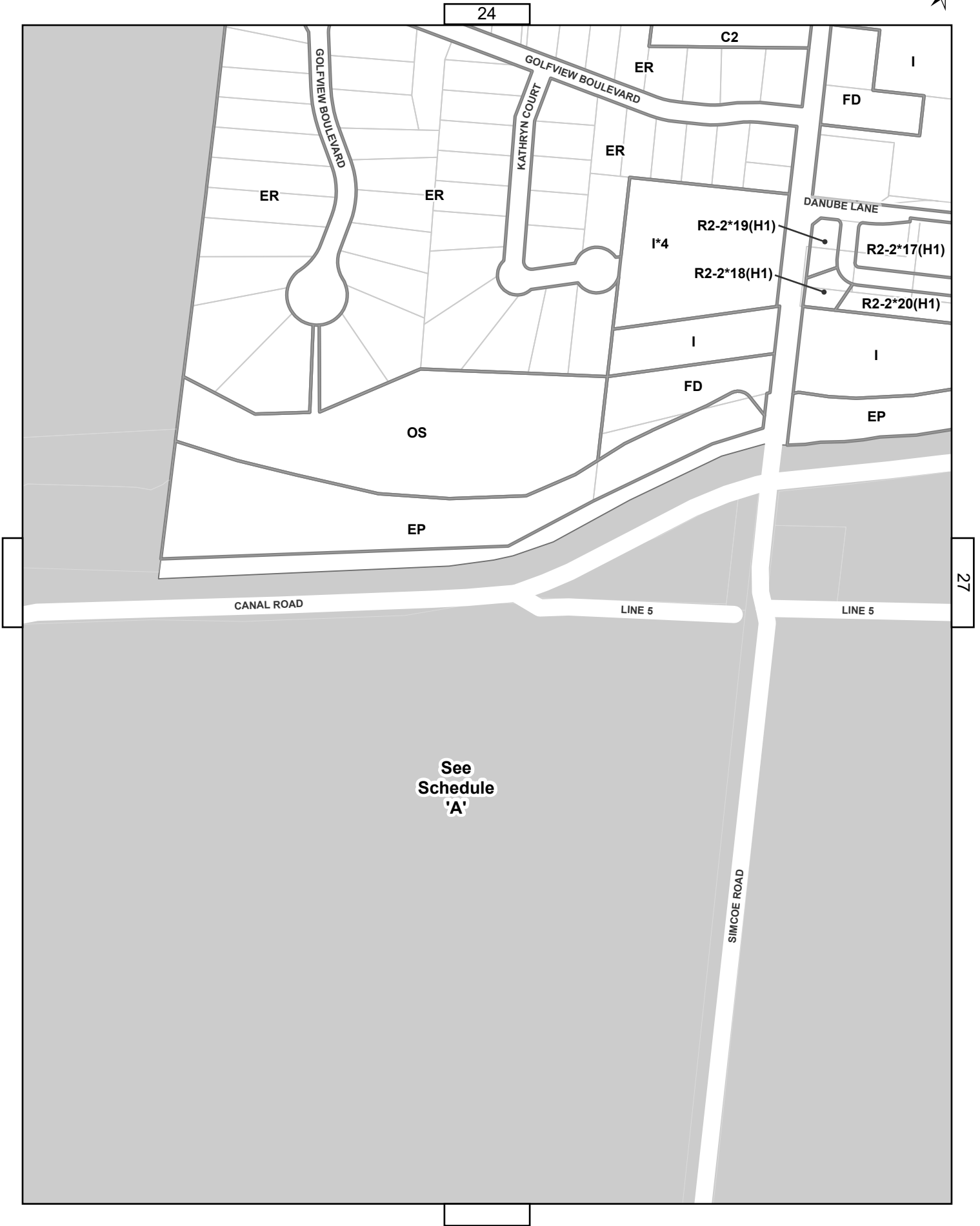

See
Schedule
'A'

24

27

24

